

FIS Map & Driving Directions to TGH Consultation Clinic



Driving Directions to Tampa General Hospital

If you are traveling South on I-275 take Exit 45A (Downtown East / West) and follow signs for Ashley Dr. Take Ashley Dr. to Kennedy Blvd. Turn right on Kennedy Blvd., and follow Hospital (H) signs to S. Hyde Park Ave. Turn left onto S. Hyde Park Ave., to TGH.

If you are traveling North on I-275 take Exit 44 (Downtown East / West) and follow signs for Ashley Dr. Take Ashley Dr. to Kennedy Blvd. Turn right on Kennedy Blvd., and follow Hospital (H) signs to S. Hyde Park Ave. Turn left onto S. Hyde Park Ave., to TGH.

From I-4 take I-275 South to Exit 45A (Downtown East / West) and follow signs for Ashley Dr. Take Ashley Dr. to Kennedy Blvd. Turn right on Kennedy Blvd., and follow Hospital (H) signs to S. Hyde Park Ave. Turn left onto S. Hyde Park Ave., to TGH.

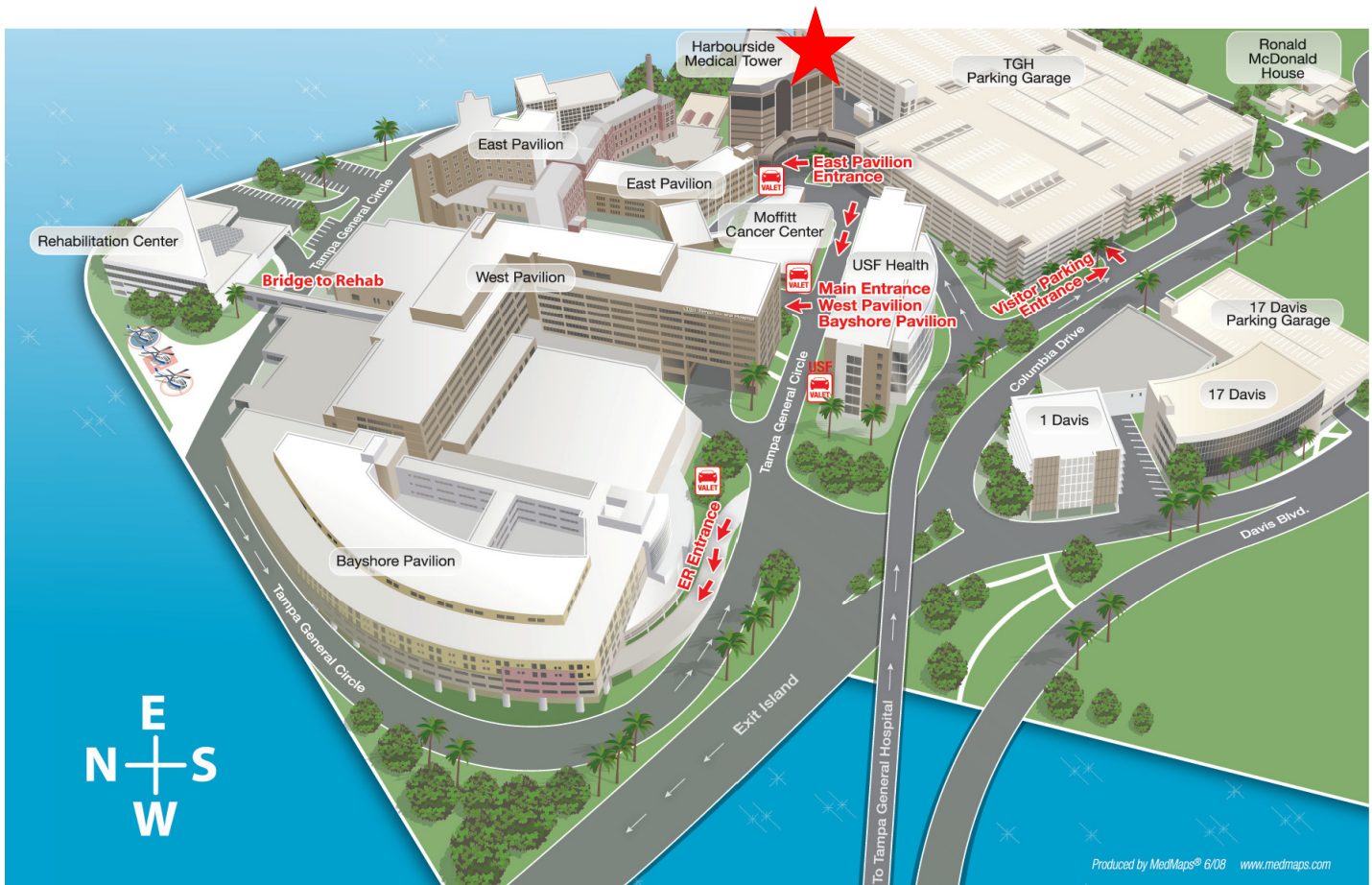

Evaluation Clinic Location: 5 Tampa General Circle, 8th Floor, Suite 820, Tampa, FL 33606

Procedure Clinic Location: 1 Tampa General Circle, 3rd Floor, 3K Registration, Tampa, FL 33606

Scheduling (813) 844-4570

After Hours (813) 844-7444

Fax (813) 844-4032

Florida Interventional Specialists Consultation Clinic located at Tampa General Hospital in the Harbourside Building at 5 Tampa General Circle, Tampa, FL 33606.

Once on Tampa General Circle follow the signs to the East Pavilion Entrance / Harbourside Building or park in the Visitor Parking Garage. First hour free. \$3 per day. The Walkway Bridge from the parking garage to the Harbourside Building is located on the 3rd floor (green level) of the parking garage.

Enter the Harbourside building through the main entrance sliding doors, continue straight to the lobby, and make a left at the Elevators. Take the Elevators to the 8th floor. (If you are entering Harbourside on the 3rd floor from the Parking garage walkway, enter the harborside through the sliding doors and follow the signs to the elevators and take to the 8th floor.)

Once on the 8th floor, exit the elevators and follow the Room number signs that include Room 820. Take a right down the hall and continue straight until the hall turns right. FIS is located in that corner in Room 820 with Florida Advanced Cardiothoracic Surgery. **See Illustration below**

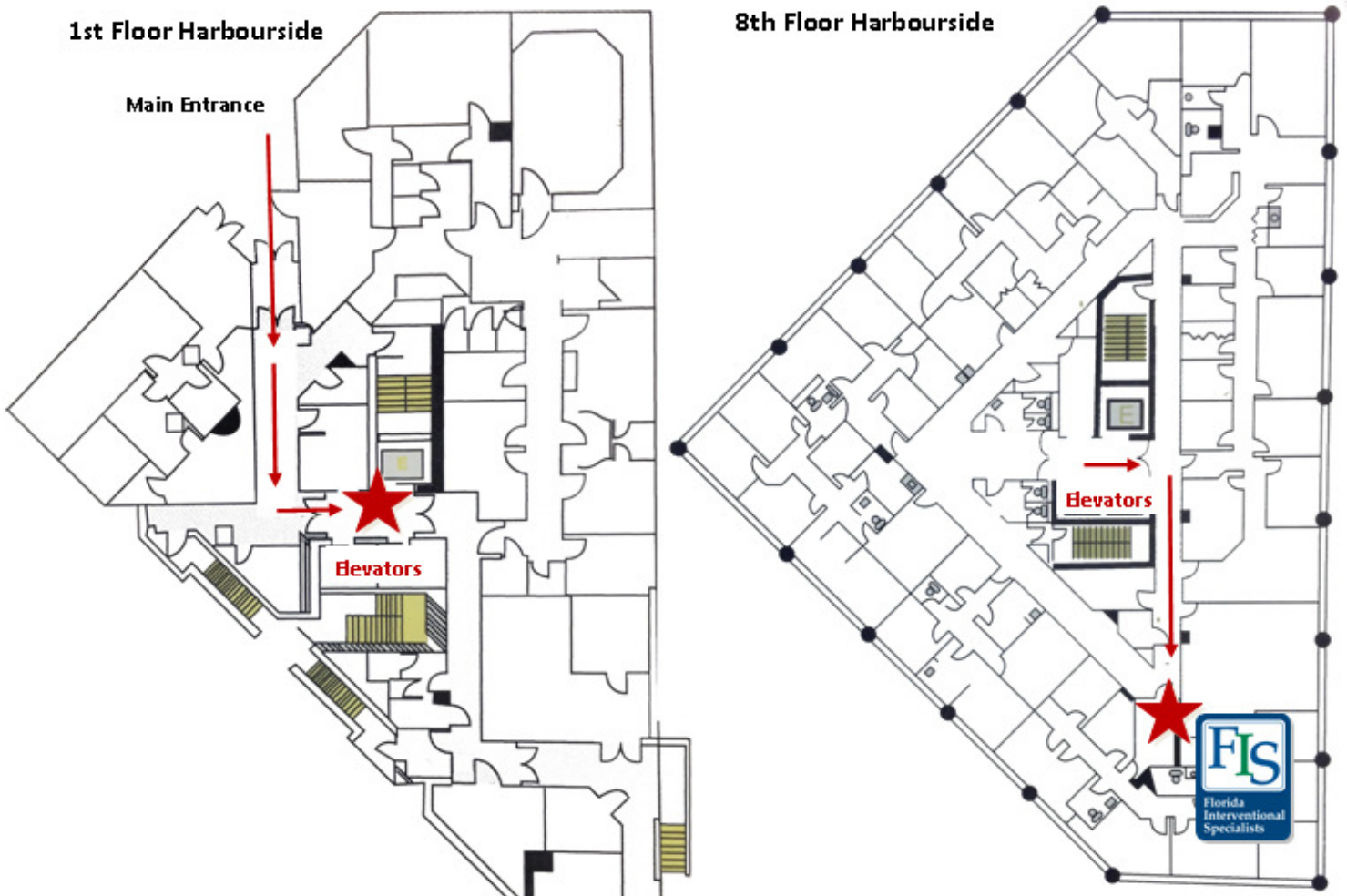

Evaluation Clinic Location: 5 Tampa General Circle, 8th Floor, Suite 820, Tampa, FL 33606

Procedure Clinic Location: 1 Tampa General Circle, 3rd Floor, 3K Registration, Tampa, FL 33606

Scheduling (813) 844-4570

After Hours (813) 844-7444

Fax (813) 844-4032

Tampa General Visitor Garage Parking Rates:

- First hour free. \$3 fee due upon exiting the garage for an hour or more parking. Cash & Credit Accepted. You can enter the Harborside Building either at ground level on the first floor or directly from the parking garage on the 3rd level. Designated Handicap Parking on Floors 1, 3, & 5.
- The Walkway Bridge from the parking garage to the Harbourside Building is located on the 3rd floor (green level) of the parking garage.
- Free courtesy shuttle from parking garage to your destination on the TGH campus. Once you have parked call (813) 844-CARS (2277).

Valet Parking

- \$5 fee due at time of parking, Cash Only.

Free Off-Site Parking Available

- Park in the TGH lot located in the 200 block of South Hyde Park Avenue.
- Shuttle buses run every 15 minutes between the lot and TGH Monday – Friday 5:30am – Midnight.
- After-hours transportation to the off-sight lot can be arranged through Security: (813) 844-7363



Evaluation Clinic Location: 5 Tampa General Circle, 8th Floor, Suite 820, Tampa, FL 33606

Procedure Clinic Location: 1 Tampa General Circle, 3rd Floor, 3K Registration, Tampa, FL 33606

Scheduling (813) 844-4570

After Hours (813) 844-7444

Fax (813) 844-4032